

# FMRC(M)5000 new

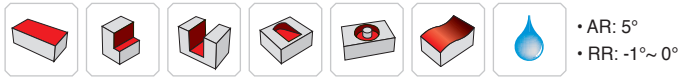
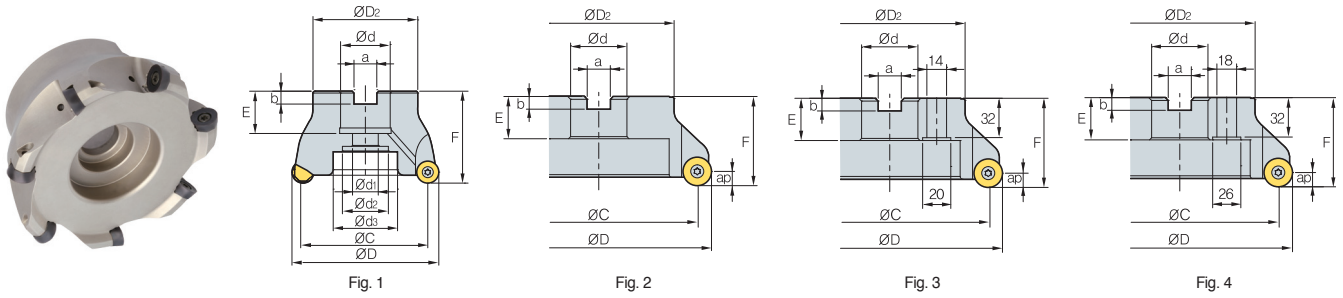

Designation		ØD	ØC	ØD2	Ød	Ød1	Ød2	Ød3	a	b	E	F	ap	kg	Fig.	Insert size	
FMRCM	5063HRP-4	4	63	47	50	22	11	18	-	10.4	6.3	20	40	8	0.43	1	16
	5063HRP-5	5	63	47	50	22	11	18	-	10.4	6.3	20	40	8	0.44	1	16
	5066HRP-5	5	66	50	50	22	11	18	-	10.4	6.3	20	40	8	0.48	1	16
FMRC (FMRCM)	5080HRP-5	5	80	64	57	25.4 (27)	14	25	35	9.5 (12.4)	6 (7)	24 (23)	50	8	0.77	1	16
	5080HRP-6	6	80	64	57	25.4 (27)	14	25	35	9.5 (12.4)	6 (7)	24 (23)	50	8	0.82	1	16
	5100HRP-6	6	100	84	67	31.75 (32)	18	26	42	12.7 (14.4)	8 (8)	32 (25)	63 (55)	8	1.42	1	16
	5125HRP-7	7	125	109	87	38.1 (40)	22	32	52	15.9 (16.4)	10 (9)	35 (29)	68 (63)	8	2.78	1	16
	5125HRP-8	8	125	109	87	38.1 (40)	22	32	52	15.9 (16.4)	10 (9)	35 (29)	68 (63)	8	2.79	1	16
	5160RP-8	8	160	144	107	50.8 (40)	-	-	100	19 (16.4)	11 (9)	38 (32)	63	8	4.01	2 (3)	16

( )Metric size

## Available inserts

		RPCT-MA	RPET-ML	RPMT-MF	RPMT-MM	RPMW													
Designation		Cermet		Coated										Uncoated		page			
		CN2000	CN30	NCM325	NC5330	NCM635	NCM545	PC2505	PC2510	PC3600	PC3700	PC6510	PC9530	PC9540	PC5300		PC5400	ST30A	H01
RPCT	1606M0-MA																		E16
RPET	1606M0E-ML																		
RPMT	1606M0E-MF																		
	1606M0S-MM																		
RPMW	1606M0S1																		

## Available arbors

Designation	Ød	Available arbors
FMRCM	5063HRP-4	BT□□-FMC22-□□
	5063HRP-5	
	5066HRP-5	
FMRC (FMRCM)	5080HRP-5	BT□□-FMA25.4-□□ BT□□-FMC27-□□
	5080HRP-6	BT□□-FMA25.4-□□ BT□□-FMC27-□□
	5100HRP-6	BT□□-FMA31.75-□□ BT□□-FMC32-□□
	5125HRP-7	BT□□-FMA38.1-□□ BT□□-FMC40-□□
	5125HRP-8	BT□□-FMA38.1-□□ BT□□-FMC40-□□
	5160RP-8	BT□□-FMA50.8-□□ BT□□-FMC40-□□

## Parts

Specification	Screw	Wrench
Ø63~Ø160	FTGA0512-P	TW20-100

Available inserts E16 Available arbors and bolt E400~E402

